

# INSTALLATION AND SERVICE MANUAL

For Installation of Bornholm 2, 3, 4 Underwater Luminaire RGBW (CV) 24V.  
Model. UBOH-60013-RGBW, UBOH-60023-RGBW and UBOH-60033-RGBW

## Product drawing (dimensions) SUITABLE FOR WET LOCATIONS

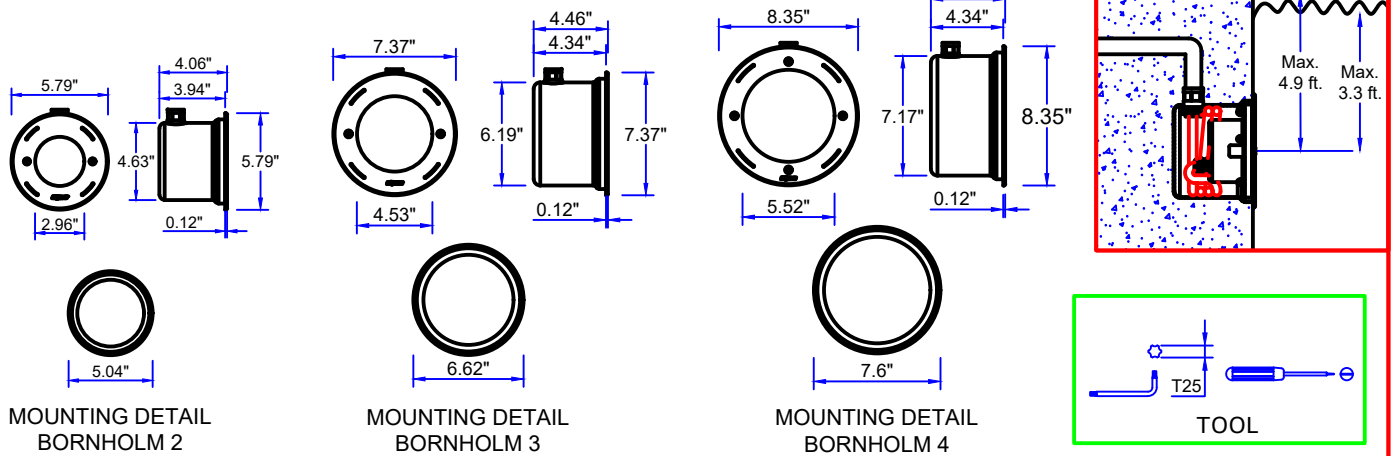

OK  
YES

NO

NO

## WIRING DIAGRAM LUMINAIRES

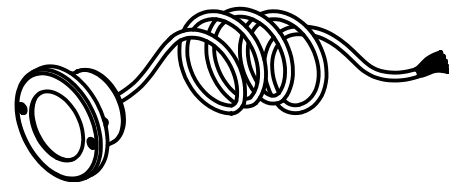
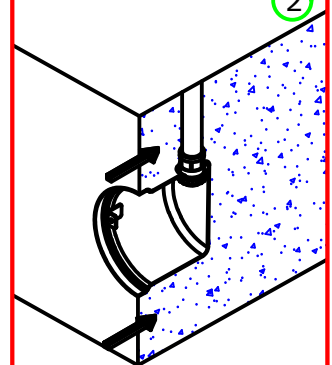
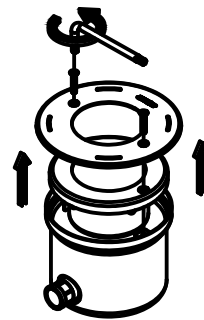
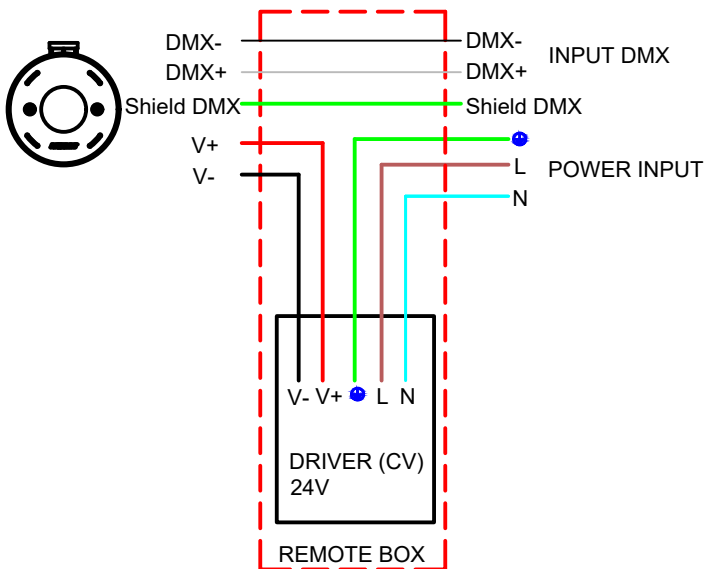

Without remote driver - Constant voltage (CV) 24V

- LIGMAN standard products are supplied with the control gear 24Vdc.  
The control gear for other voltages and frequencies is available upon request, please consult us for more details.
- LIGMAN luminaires are designed to conform IEC 60598 2-18 standard.  
Technical amendments and modifications techniques reserved.

**Ligman Lighting USA**

7144 NE Progress Court, Hillsboro  
Oregon, 97124, USA  
Tel : 503 645 0500 | Fax : 503 645 8100

[www.ligmanlightingusa.com](http://www.ligmanlightingusa.com)

### 3-WAY CONNECTOR 5 PIN IP68

4

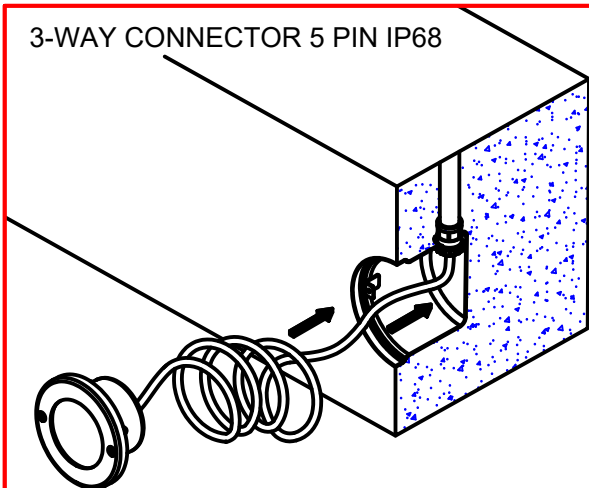

- 5
- 1 DMX+ (Gray)
  - 2 DMX- (Black)
  - 3 24V+ (Brown)
  - 4 24V- (Blue)
  - 5 Shield DMX (Green-Yellow)

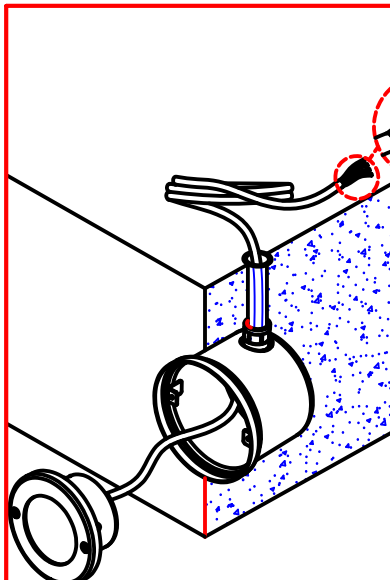

Cable Connector  
3 way Waterproof  
Customer Supply

6

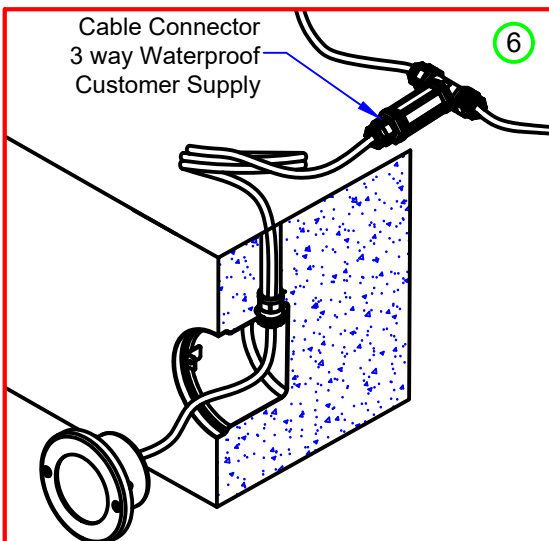

7

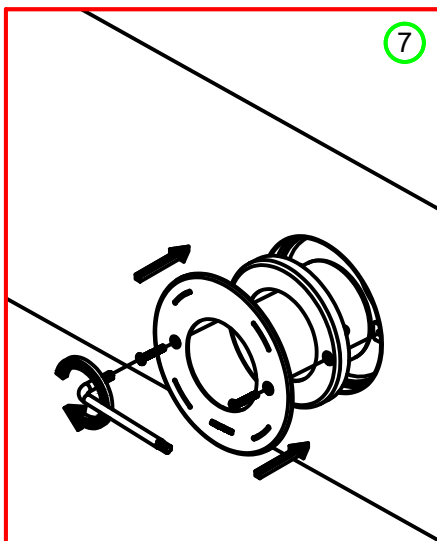

8

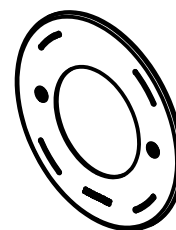

### DMX (RGBW) STRUCTURE

**TOTAL LENGTH PER OUT DOES NOT EXCEED 300m. [984ft.]**

**MAX: 32 DEVICES PER OUTPUT (MORE USING BOOSTERS OR SPLITTERS)**

#### ROOM CONTROL

120 - 277 Vac.

DMX CONTROLLER

5 WIRE CABLE

Remote Driver  
24Vdc.

5 WIRE

(1)-RGBW

(2)-RGBW

(3)-RGBW

(4)-RGBW

(5)-RGBW

(6)-RGBW

